

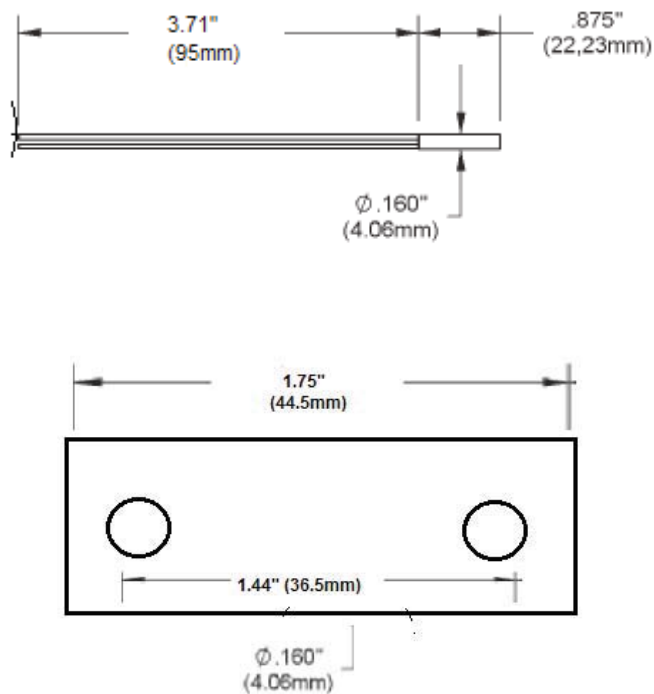

Technical Data

Temperature output signal	NTC 10k Ohm, Type II
Connectors	1/4" female spade insulated connectors, 3 ft. cable
Accuracy	$\pm 0.36^{\circ}\text{F}$, ($\pm 0.2^{\circ}\text{C}$)
Stability drift	less than 0.036°F/yr [0.02°C/yr]
Material	etched Teflon, plenum-rated & FEP jacketed cable; galvanized t-bracket
Ambient temperature range	-67°F to $+176^{\circ}\text{F}$ (-55°C to $+80^{\circ}\text{C}$)

Dimensions in Inches [mm]



Installation

Avoid mounting in areas where acid fumes or other deteriorating vapors can attack the metal parts, or in areas where escaping gas or other explosive vapors are present.

Mount the sensor in a position that will allow for proper clearance for installation, servicing, wiring, and removal.

Using the dimensions as a reference, mount the 10K Sensor on the outside of the dampers to measure outside temperature, or inside the return air duct to measure the return temperature. If mounted outside, the sensor must be placed within hood behind the outdoor air filter. It needs to be protected from direct exposure to water (snow/rain) and direct exposure to sunlight (UV radiation).

Secure the sensor with #8 self-tapping screws (included in kit) using a size 16 or 18 drill.

Wiring Diagram

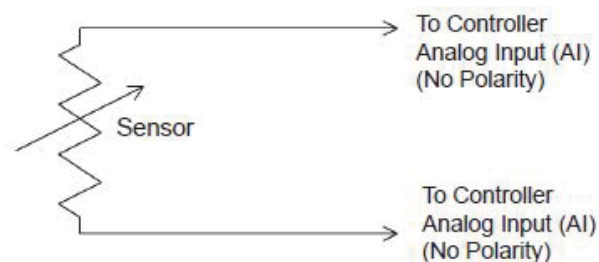

ECON-ZIP-10K

ZIP Economizer Connection Points

SAT (+/-)
OAT (+/-)
RAT (+/-)